

ROYSON ENGINEERING COMPANY

130 N. PENN ST. HATBORO, PA. 19040 PHONE #215-675-2800 FAX#215-675-3035
 CDT-IS BOWL TYPE VIBRATORY HEATED COB DRYER WITH RISING CHANNEL
 BULLETIN #792

8-CDT-IS

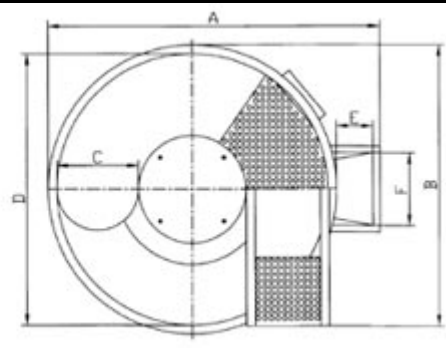
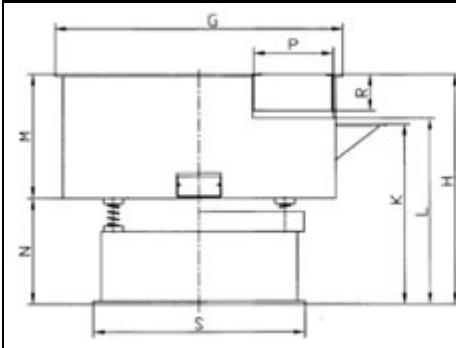

DIM. INCHES	A	B	C	D	E	F	G	H	K	L	M	N	P	R	S	WEIGHT
	60	42	15	49	8.6	15.7	52	41	31	32	21	19	14.5	6	52	1345 LBS

OPTIONAL STEEL DUST COVER



• THE 8-CDT-IS COB DRYER IS AN EXCELLENT CHOICE FOR COB DRYING PARTS IN A CONTINUOUS MODE BY SIMPLY CLOSING OFF A SECTION OF THE SCREEN DECK. THE WIDE LOAD CHUTE ALLOWS EASY LOADING OF PARTS INTO THE MACHINE.

- 8 CUBIC FOOT CAPACITY
- 2400 WATT VIBRATION PROOF HEATING ELEMENT MOUNTED UNDER THE SCREEN DECK.
- 4 HP MOTOR, VARIABLE SPEED DRIVE

CONTROL PANEL 208/240/460/3/60



Copyright/2010