

# ROYSON ENGINEERING COMPANY

130 N. PENN ST. HATBORO, PA. 19040 PHONE #215-675-2800 FAX#215-675-3035  
 CDT-IS BOWL TYPE VIBRATORY HEATED COB DRYER WITH RISING CHANNEL  
 BULLETIN #794

## 20-CDT-IS

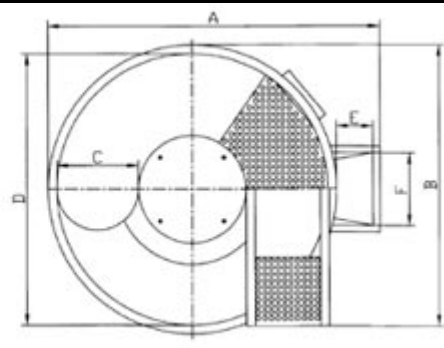
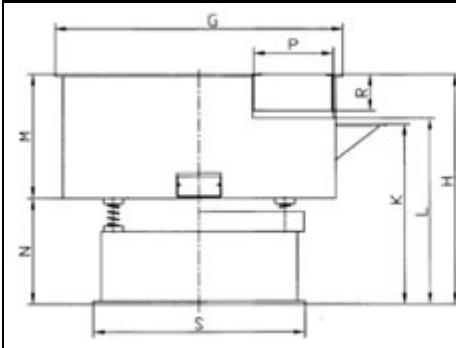

DIM. INCHES	A	B	C	D	E	F	G	H	K	L	M	N	P	R	S	WEIGHT
	77	54	19	64	10	23	68	47	35	36	26.5	19	19	9	68	2650 LBS

### OPTIONAL STEEL DUST COVER



• THE 20-CDT-IS COB DRYER IS AN EXCELLENT CHOICE FOR COB DRYING PARTS IN A CONTINUOUS MODE BY SIMPLY CLOSING OFF A SECTION OF THE SCREEN DECK. THE WIDE LOAD CHUTE ALLOWS EASY LOADING OF PARTS INTO THE MACHINE.

- 20 CUBIC FOOT CAPACITY
- 5400 WATT VIBRATION PROOF HEATING ELEMENT MOUNTED UNDER THE SCREEN DECK.
- 7.3 HP MOTOR, VARIABLE SPEED DRIVE

### CONTROL PANEL 208/240/460/3/60



Copyright/2010